

Outside Air Temp Sensor

From e8CON

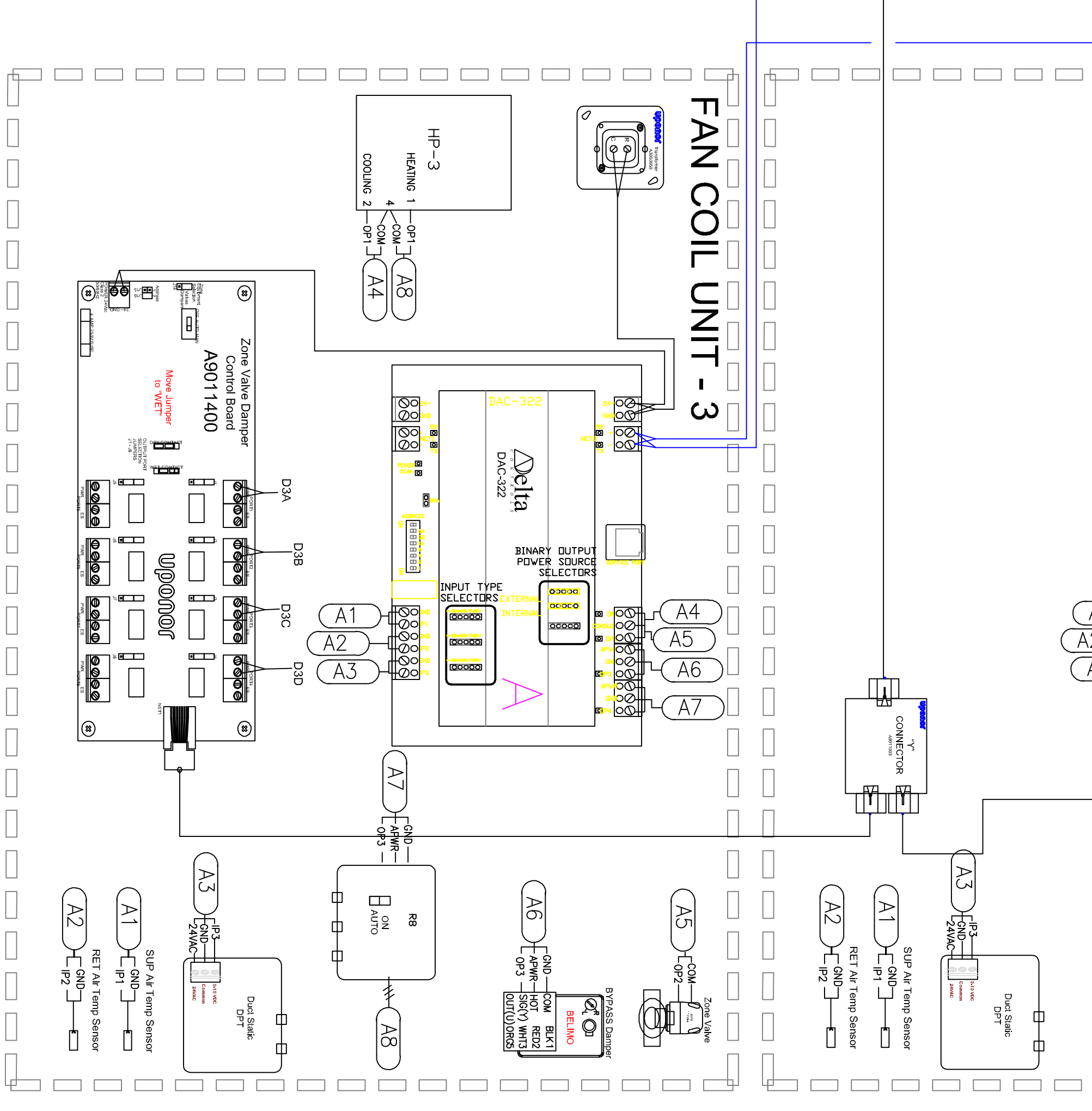
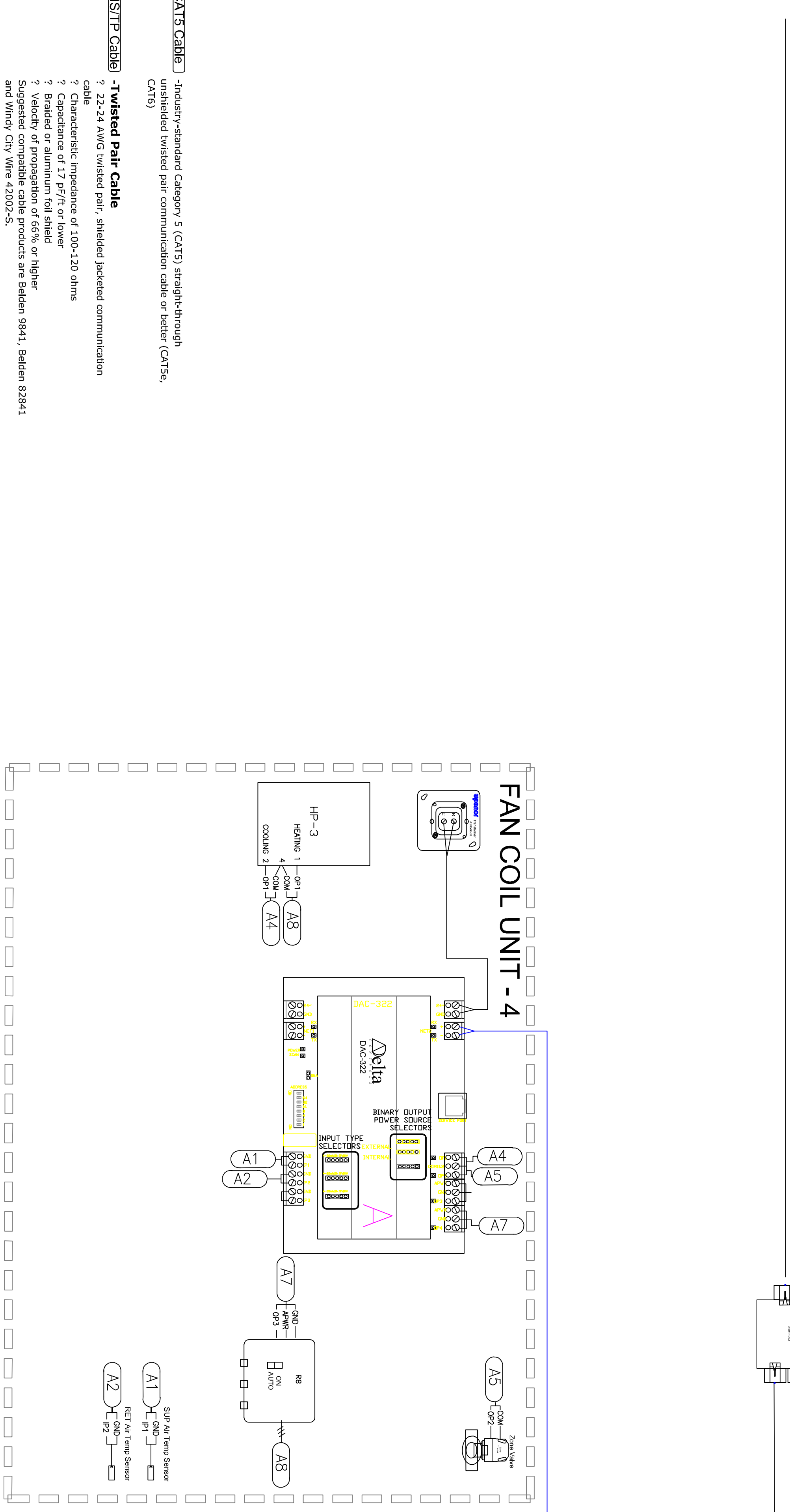
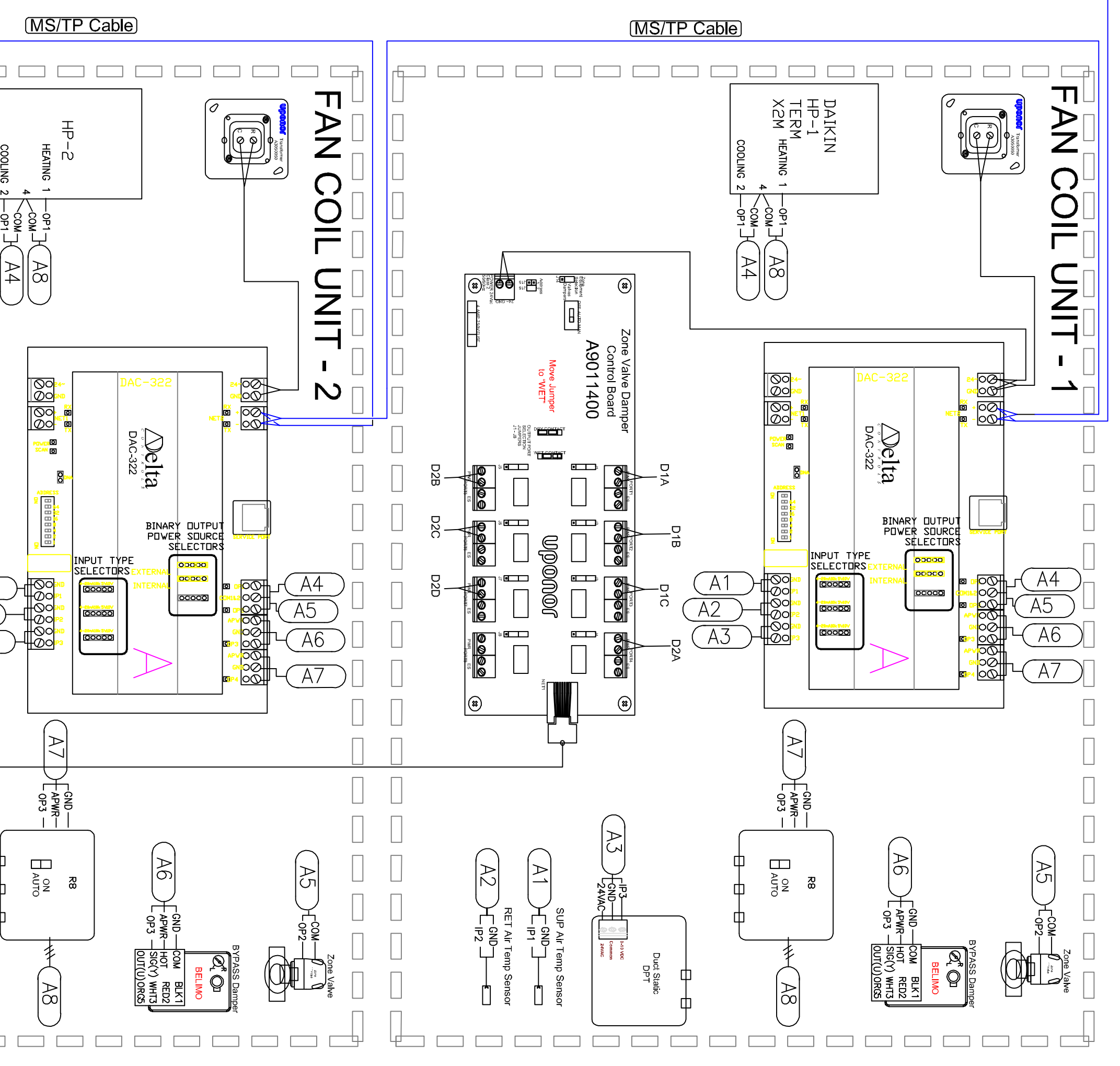
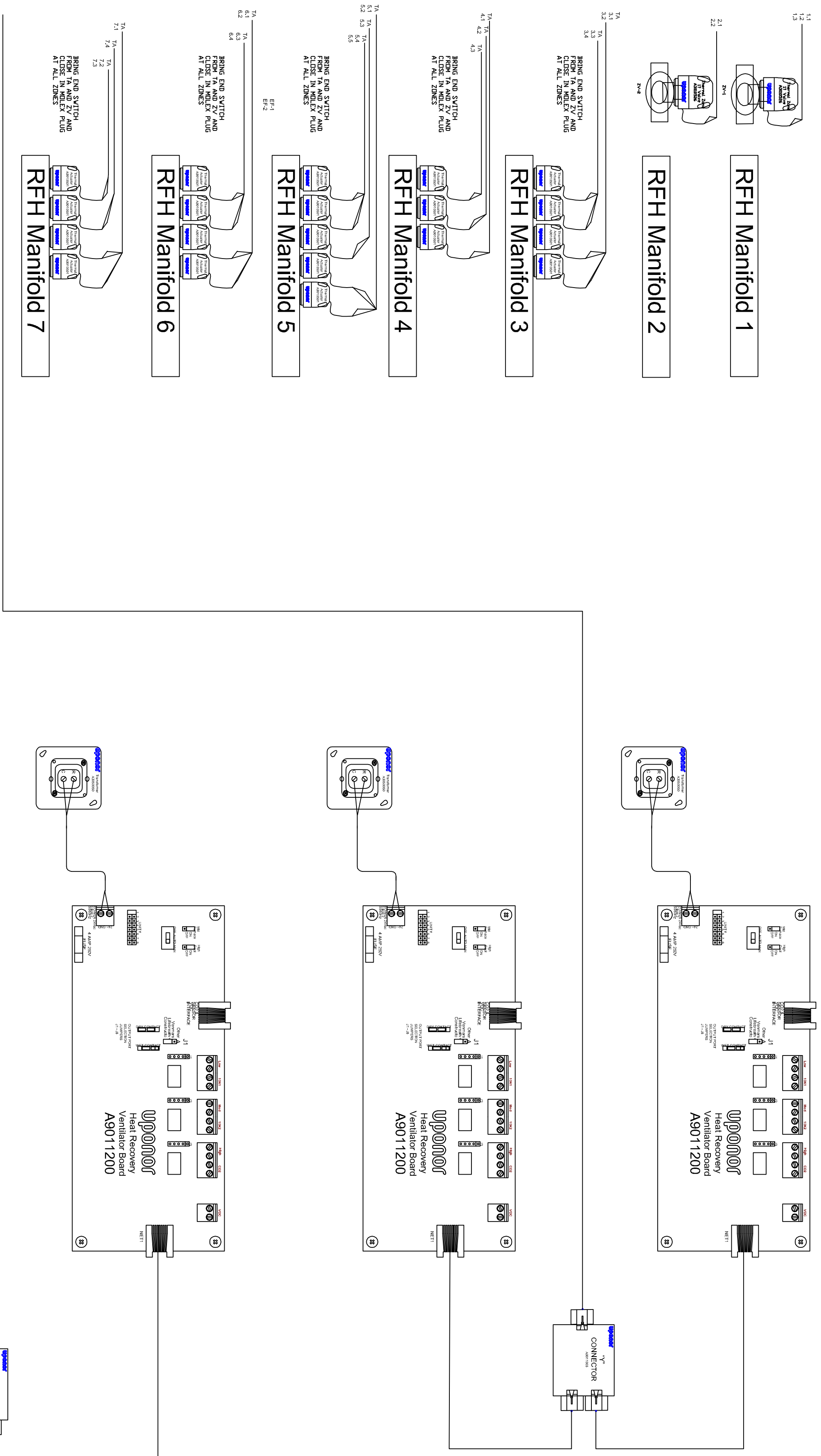

- CA15 CABLE** -Industry-standard Category 5 (CAT5) straight-through unshielded twisted pair communication cable or better (CAT5e, CAT6)
- MS/TP Cable** -Twisted Pair Cable
- ? 22-24 AWG twisted pair, shielded jacketed communication cable
 - ? Characteristic impedance of 100-120 ohms
 - ? Capacitance of 17 pF/ft or lower
 - ? Braided or aluminum foil shield
 - ? Velocity of propagation of 66% or higher
 - ? Suggested compatible cable products are Belden 9841, Belden 82841 and WinWay City Wire 42002-S.
- 2-Conductor 18-20 AWG, Unshielded
 - 3-Conductor 18-20 AWG, Unshielded
 - 5-Conductor 18-20 AWG, Unshielded

FIELD

UPONOR

GIANCARLO

DRAWN BY: MAC

3-4-2011

This is a conceptual drawing only. It is not intended to describe a complete system. It determines the necessary components for and configuration of the particular system being installed, including equipment and piping. The contractor is responsible for determining the appropriate size and configuration of the contractor's equipment and design that system and to ensure the system meets the code requirements.

D 1.0